

KL41 PLUS

LONG RANGE LED GUN LIGHT

USER MANUAL

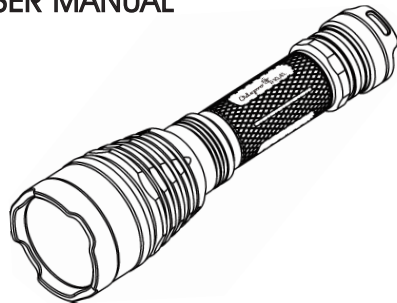

Thank you for purchasing the KL41 PLUS flashlight!
 Please read this manual carefully before using this product.

PACKAGE INCLUDED

1xKL41, 3xLED module, 1xBattery charger, 2x18650 battery, 1xRemote switch, 1xUniversal rapid mount, 1xPicatinny rail mount, 1xLanyard, 4xSpare O-ring, 1xWarranty card, 1xUser manual

PRODUCT INSTRUCTION

KL41 PLUS is a powerful, long range, waterproof hunting light featuring interchangeable color LED modules and stepless dimming remote switch. The LED modules can be changed in the field without tools in less than 20 seconds for those wishing to use or experiment with a different led color. One unique feature about this light is the remote switch. The switch is silent when activated for constant on/off function. You will not hear any clicking that can scare off your target during hunting. The KL41 PLUS gun light is an ideal hunting kit for hunting enthusiasts.

PRODUCT FEATURES

- ✓ High intensity LEDs with 50,000 hours lifespan
- ✓ Rapid LED module change without tools for your preference
- ✓ IPX-8 standard weatherproof design allows it to be used during heavy rain
- ✓ Made from precision machined high grade 6061 aircraft aluminum
- ✓ Matte black finish and non-reflective with military grade type III hard anodization

- ✓ Versatile usage as a handheld, scope mounted or picatinny rail mounted

HOW TO OPERATE

HOW TO OPERATE

CONSTANT-ON: Full press the tailcap switch till hearing "click", then the flashlight is on.

BUILT-IN MEMORY FUNCTION:

From off position, click the tailcap switch, the light will return to the mode the last time you were using over 3 seconds before turning off.

STROBE FUNCTION: When the light is off, half press the tailcap switch to change output mode to strobe. Full press the tailcap switch till hearing "click", then the flashlight enters strobe mode.

BRIGHTNESS CHANGE:

KL41 with white LED module has five output modes: low-middle-high-strobe-SOS. It works from low, middle, high, strobe and SOS mode in turn. With the light off, quickly half press tailcap switch to change outputs.

Red, green, IR850 as well as white light modules are offered, and you can make a choice on your own demand. They are single output mode except for white.

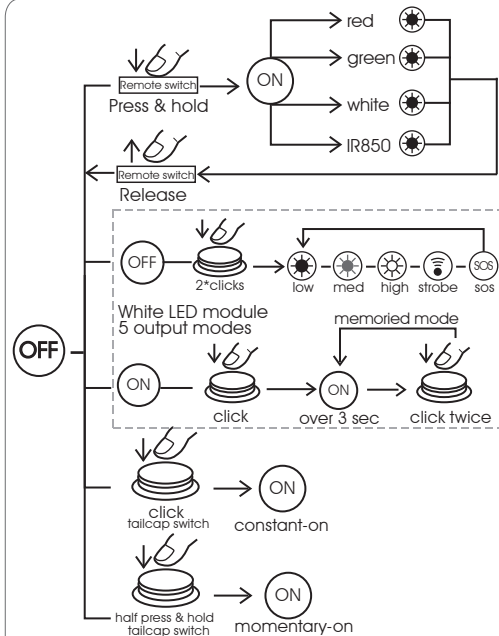

HOW TO USE REMOTE-SWITCH

The KL41 PLUS comes with a remote pressure switch.

Take down the original tailcap and fit on the remote switch to the flashlight for hunting. The remote switch for KL41 PLUS activates whatever mode the light has been set to and can be used with any long gun or shotgun (not for pump action weapons). It doesn't make a noisy "click" sound once you press it with gloves.

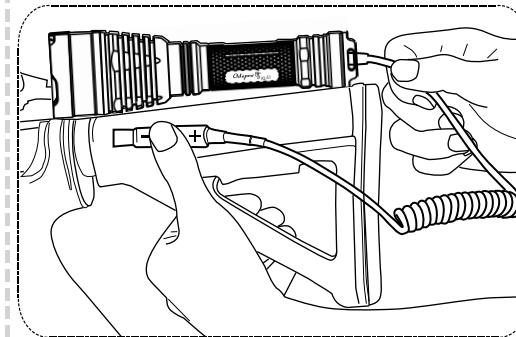

HOW TO MOUNT(Picatinny rail mount)

K185 is a versatile flashlight bracket, the net weight is only 82g, which can be mounted with scope, laser sight, firearm or other tactical equipments. Please refer to the following figure.

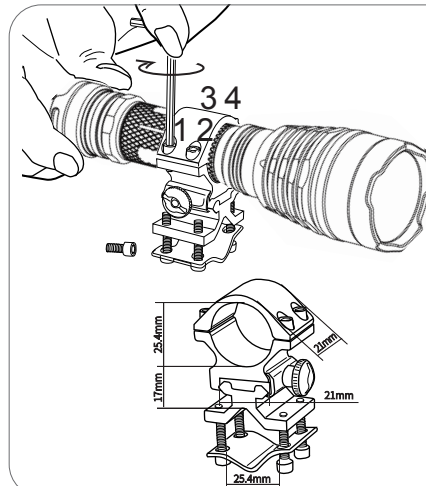

HOW TO MOUNT (Universal rapid mount)

Universal rapid mount is another versatile flashlight bracket, the net weight is only 88g, which can be mounted with scopes. Please refer to the following figure.

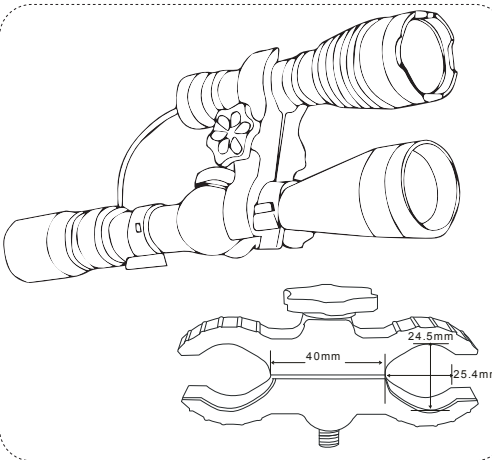

SPECIFICATIONS

LED colors	Run time	Beam Distance
White	1.1HOURS	420 YARDS
Red	2.5HOURS	240 YARDS
Green	2.5HOURS	300 YARDS
IR850	2.5HOURS	

*Infrared is not visible to the human eye. Use of IR viewing device is required

WHITE	RED	GREEN	IR850
860 lumens	150 lumens	200 lumens	210 lumens
IMPACT 1M/(3.28ft)			
LENGTH 178mm(7.0in)			
BEZEL DIAM 48.5mm / 1.9in			
WEIGHT (w/o battery) 230g / 8.11oz			

*The specifications in the chart above claim to ANSI/NEMA FL1-2009 Standards. Tests are performed with 1X 18650 battery (3.7V, 3000mAh). All specification are subject to change without prior notice.

HOW TO CHARGE BATTERY

When the battery is low, the light will start to shine weakly. We suggest you charge the batteries after every use to keep them ready to use. Place the battery properly into the charger.

- ✓ Red LED : charging in progress.
- ✓ Green LED : charging fully completed.
- * Please ensure the positive end (+) pointing to the head of light and insert the battery properly. If the battery is not installed correctly, the light can not turn on properly.



MODULE REPLACEMENT

- 1.Remove the head of KL41 PLUS
- 2.Unscrew and remove the LED module
- 3.Replace with different color LED module
- 4.Screw up the head of KL41 PLUS as far as it can go.

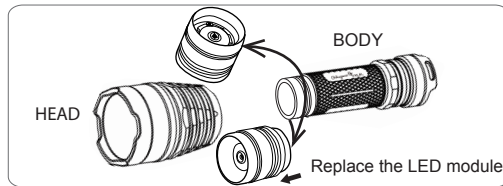
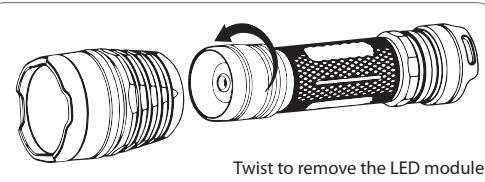

FLASHLIGHT MAINTENANCE

- 1.Please keep the battery positive pole (+) towards the flashlight head (The LED direction).
- 2.Odepro recommends using excellent quality battery. If the light will not be used for an extended period, remove the battery to avoid damage from electrolyte leakage or battery explosion.

3.Long-term use can result in O-ring abrasion. Check the condition of O-rings every time you open the body of the light. Replace the ring with an approved spare to keep the light properly sealed against water.

4.Please clean the contacts of your light periodically to keep the light performance good, especially when the light flickers or does not light up. There are probably several reasons for a flickering or not working light as following:

Reason A: The battery need to be replaced. Solution: Replace battery (please confirm the correct installation of anode and cathode).

Reason B: The threads, PCB board contact or other contacts are dirty.

Solution: Clean the contact points with a cotton swab soaked in rubbing alcohol. If the above methods don't work, please refer to the warranty policy and contact us for customer service.

Danger:

Never point the flashlight into your eyes or the eyes of other people otherwise it will cause your eyes blind or get hurt.

WARRANTY

(1)30 days free replacement: Return to Odepro for free replacement.

(2) 24 months free repair: Return to Odepro for repair.

(3) Limited lifetime warranty: If problems develop after 24 months of the purchase, we will charge for parts. The total repair fee is assessed according to the cost of the replaced materials.

This warranty does not cover normal wear and modifications, misuse, disintegrations, negligence, accidents, improper maintenance, or repair by anyone other than Odepro itself.

CUSTOMER SERVICE: service@odepro.com

Odepro Technology Co., Ltd.

Add: 7F,Building 6,Yusheng Industrial Park,Gushu, Xixiang,Baoan,Shenzhen,China 518102

Tel: +86-755-36538983

Fax: +86-755-29454989

www.odepro.com



f /szodepro



@OdeproAmazon

Scan to connect and interact with us :